

CUSTOMER SPECIFICATION

DSG8

REV	DESCRIPTION	DATE	BY
A	PRELIMINARY DESIGN	09/26/17	MD
B	Adjust to Match PCB	10/3/17	MD

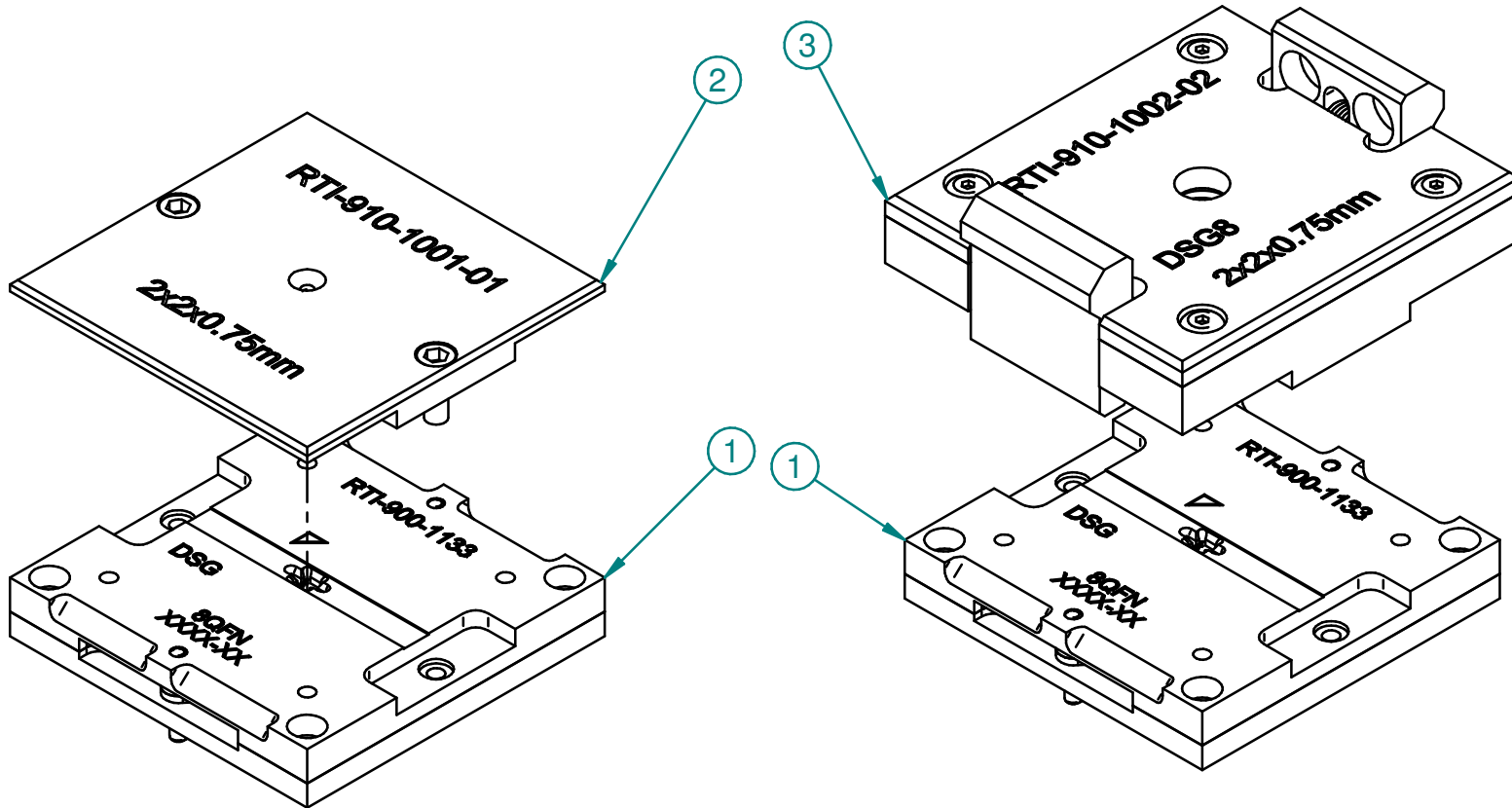

Item	Part Number	Rev	Title	Qty
1	1007120-M	A	Socket Assembly	1
2	1001639-M	A	FA Lid Assembly	1
3	1007141-M	A	Dual Latch Lid Assembly	1

RTI CONFIDENTIAL		WWW.TESTFIXTURES.COM	
<small>THESE DRAWINGS AND THE DATA CONTAINED THEREIN, ARE THE EXCLUSIVE PROPERTY OF RTI AND IS ISSUED IN STRICT CONFIDENCE AND SHALL NOT WITHOUT THE WRITTEN PERMISSION OF RTI, BE USED FOR ANY PURPOSE WHATSOEVER, EXCEPT THE MANUFACTURE OF ARTICLES FOR RTI.</small>	<small>THIRD ANGLE PROJECTION</small> 	<small>MATERIAL:</small> _____ <small>FINISH:</small> _____	<small>ENG BY:</small> MD <small>DWN BY:</small> MD
	<small>UNLESS OTHERWISE SPECIFIED, DIMENSIONS ARE IN INCHES:</small> .XX = ± .01 .XXX = ± .002 .XXXX = ± .0005	<small>CHECK BY:</small> _____ <small>DATE:</small> 09/26/17	ROBSON TECHNOLOGIES, INC. 135 E. MAIN AVE., STE. 130, MORGAN HILL, CA 95037 PH: 408-779-8008 FAX: 408-782-7132

REV	DESCRIPTION	DATE	BY
A	PRELIMINARY DESIGN	09/26/17	MD
B	Adjust to Match PCB	10/3/17	MD

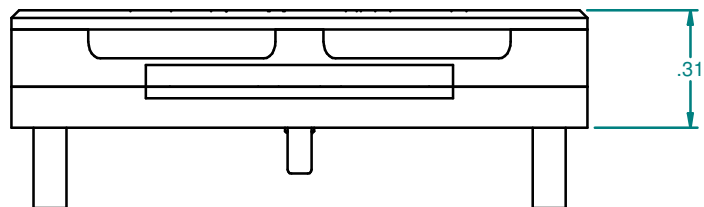
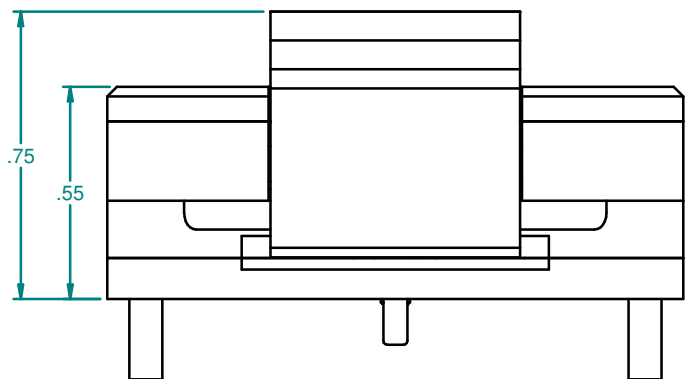
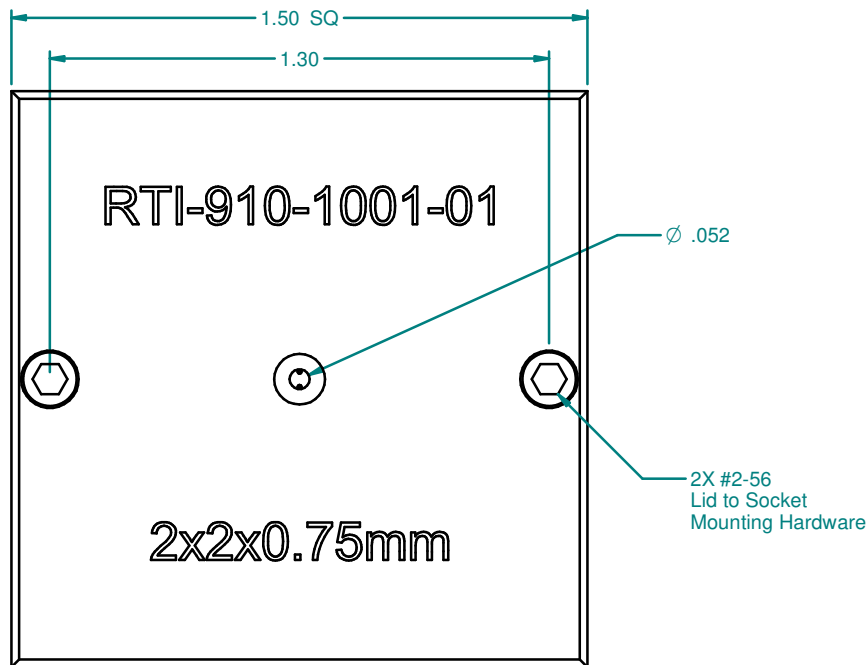
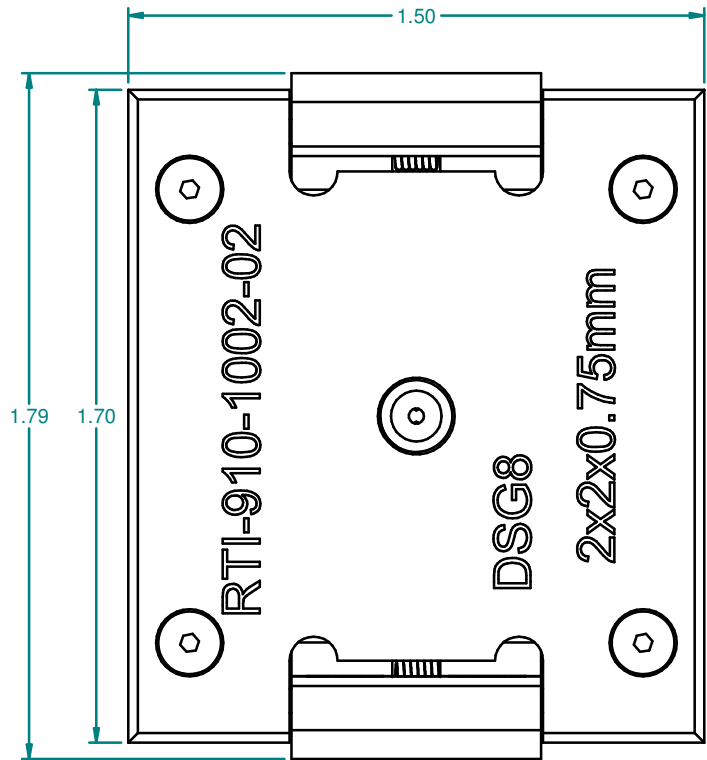

RTI CONFIDENTIAL WWW.TESTFIXTURES.COM

THESE DRAWINGS AND THE DATA CONTAINED THEREIN, ARE THE EXCLUSIVE PROPERTY OF RTI AND IS ISSUED IN STRICT CONFIDENCE AND SHALL NOT WITHOUT THE WRITTEN PERMISSION OF RTI, BE USED FOR ANY PURPOSE WHATSOEVER, EXCEPT THE MANUFACTURE OF ARTICLES FOR RTI.

 THIRD ANGLE PROJECTION	MATERIAL:	ENG BY: MD	 ROBSON TECHNOLOGIES, INC. 135 E. MAIN AVE., STE. 130, MORGAN HILL, CA 95037 PH: 408-779-8008 FAX: 408-782-7132
	FINISH:	DWN BY: MD	
UNLESS OTHERWISE SPECIFIED, DIMENSIONS ARE IN INCHES: .XX = ± .01 .XXX = ± .002 .XXXX = ± .0005		CHECK BY:	DRAWING NUMBER: 1007120-C
		DATE: 09/26/17	REV: B PAGE: 2 of 8
		TITLE: Customer Specification	

REV	DESCRIPTION	DATE	BY
A	PRELIMINARY DESIGN	09/26/17	MD
B	Adjust to Match PCB	10/3/17	MD

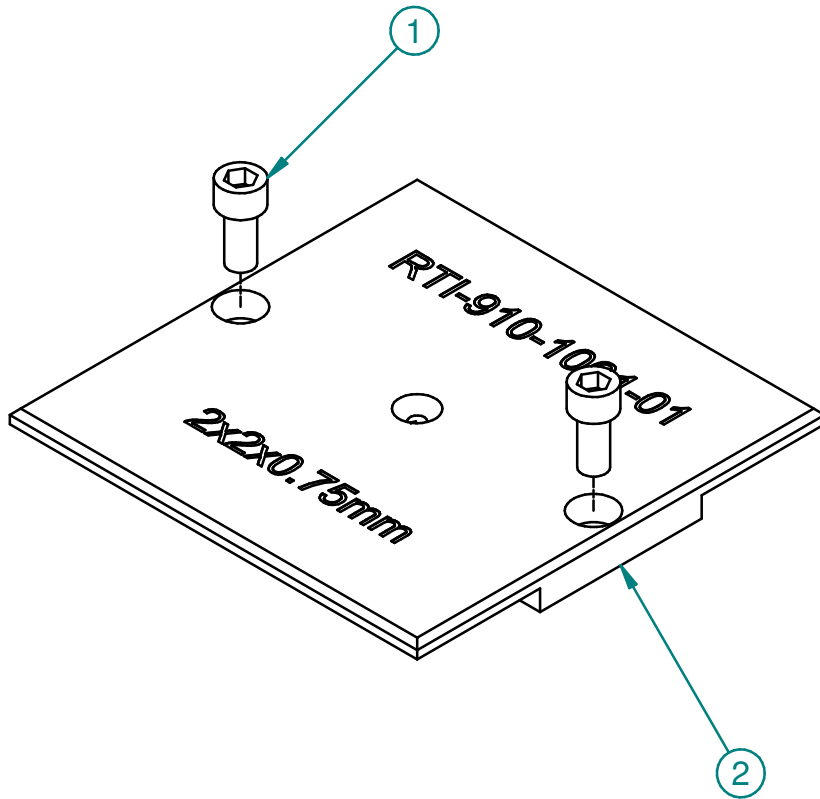

FA Lid Assembly

Sales Part# 910-1001-01-2x2x0.75

Material Specification:

FA Lid - Anodized Aluminum

Item	Part Number	Rev	Title	Qty
1	01-2-56x.187-MA-SCA-SS		Socket Cap Screw	2
2	L-1001-L-325	2	FA Lid	1

RTI CONFIDENTIAL		WWW.TESTFIXTURES.COM	
<small>THESE DRAWINGS AND THE DATA CONTAINED THEREIN, ARE THE EXCLUSIVE PROPERTY OF RTI AND IS ISSUED IN STRICT CONFIDENCE AND SHALL NOT WITHOUT THE WRITTEN PERMISSION OF RTI, BE USED FOR ANY PURPOSE WHATSOEVER, EXCEPT THE MANUFACTURE OF ARTICLES FOR RTI.</small>	<small>THIRD ANGLE PROJECTION</small> 	<small>MATERIAL:</small> 	<small>ENG BY:</small> MD
	<small>UNLESS OTHERWISE SPECIFIED, DIMENSIONS ARE IN INCHES:</small> .XX = ± .01 .XXX = +.002 .XXXX = ±.0005	<small>FINISH:</small> 	<small>DWN BY:</small> MD
		<small>CHECK BY:</small> 	<small>DRAWING NUMBER:</small> 1007120-C
		<small>DATE:</small> 09/26/17	<small>REV.:</small> B <small>PAGE:</small> 3 of 8 <small>TITLE:</small> Customer Specification

REV	DESCRIPTION	DATE	BY
A	PRELIMINARY DESIGN	09/26/17	MD
B	Adjust to Match PCB	10/3/17	MD

Dual Latch Lid Assembly

Sales Part# 910-1002-02-2x2x0.75

Material Specification:

Lid Top - Anodized Aluminum

Lid Base/Pressure Plate/Latches -

High Performance Plastic

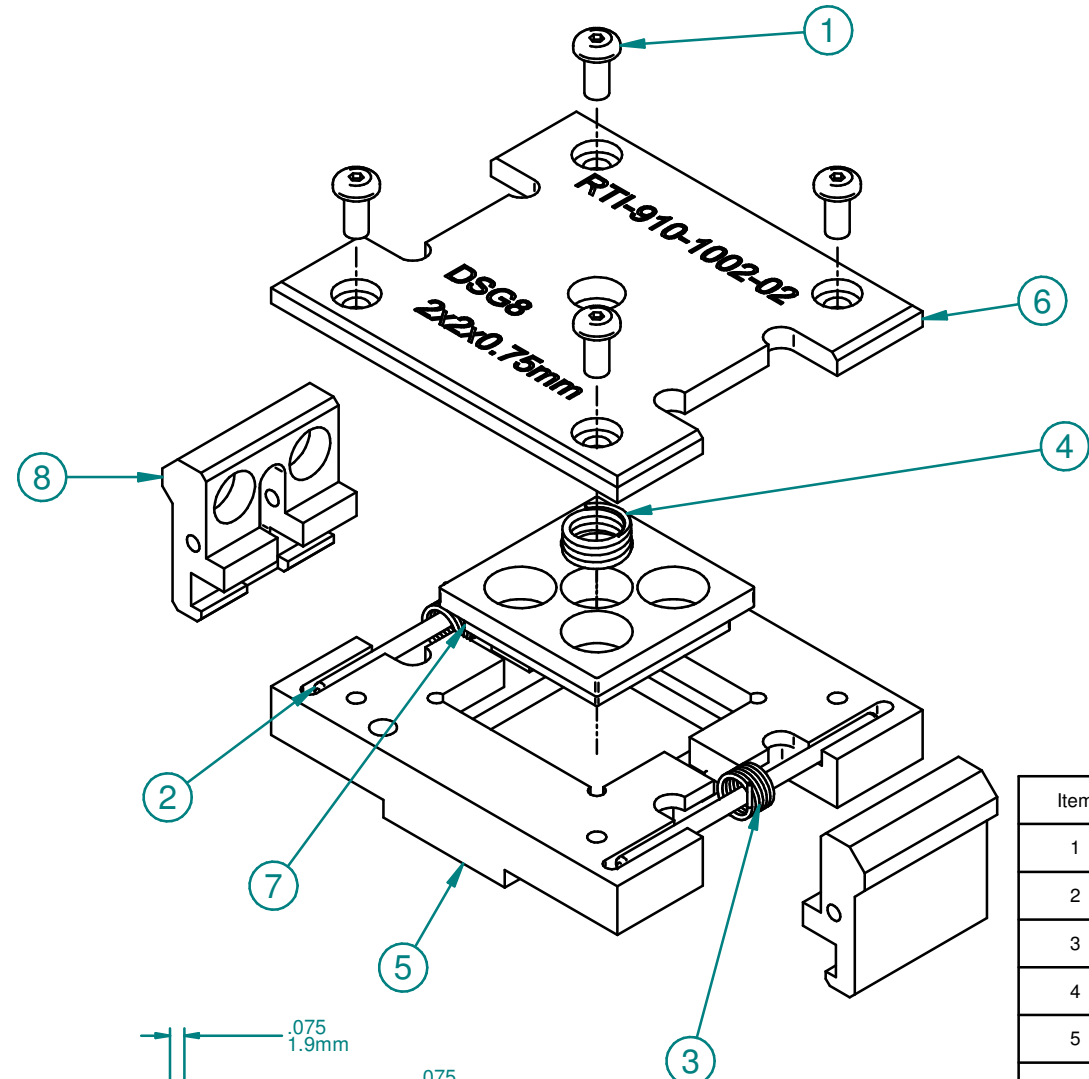

Item	Part Number	Rev	Description	Qty
1	01-2-56x.187-MA-BNA-SS		Button Head Screw	4
2	02-.0625x1.25-S-S		Dowel Pin	2
3	03-.172x.125x.017-TR02-M		Torsion Spring Right-Handed	2
4	03-.24x.375x.026-C-S		Spring	1
5	L-1002-LB-015	2	Lid Base	1
6	L-1002-LT-396	A	Lid Top	1
7	L-1002-P-396	A	Pressure Plate	1
8	L-xxxx-T-042	2	Latch	2

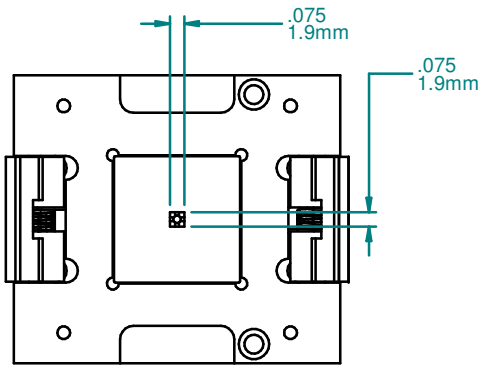

RTI CONFIDENTIAL

WWW.TESTFIXTURES.COM

THESE DRAWINGS AND THE DATA CONTAINED THEREIN, ARE THE EXCLUSIVE PROPERTY OF RTI AND IS ISSUED IN STRICT CONFIDENCE AND SHALL NOT WITHOUT THE WRITTEN PERMISSION OF RTI, BE USED FOR ANY PURPOSE WHATSOEVER, EXCEPT THE MANUFACTURE OF ARTICLES FOR RTI.

THIRD ANGLE PROJECTION

MATERIAL: _____ FINISH: _____

ENG BY: MD DWN BY: MD

CHECK BY: _____ DATE: 09/26/17

UNLESS OTHERWISE SPECIFIED, DIMENSIONS ARE IN INCHES:
 .XX = ± .01
 .XXX = ± .002
 .XXXX = ± .0005

DRAWING NUMBER: 1007120-C REV. B PAGE: 4 of 8

TITLE: Customer Specification

RTI ROBSON TECHNOLOGIES, INC.
 135 E. MAIN AVE., STE. 130, MORGAN HILL, CA 95037
 PH: 408-779-8008 FAX: 408-782-7132

REV	DESCRIPTION	DATE	BY
A	PRELIMINARY DESIGN	09/26/17	MD
B	Adjust to Match PCB	10/3/17	MD

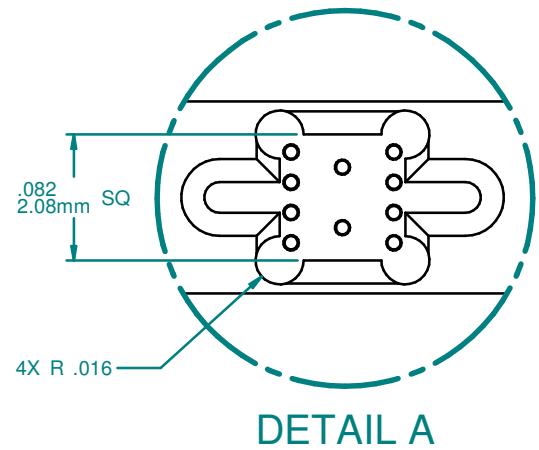
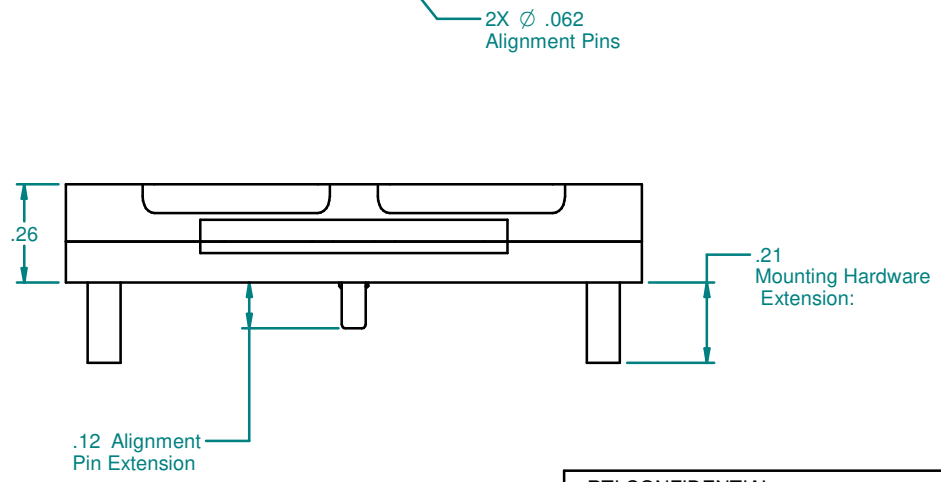
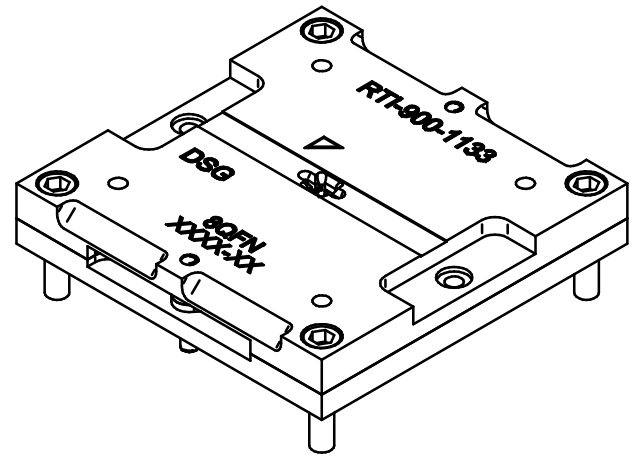
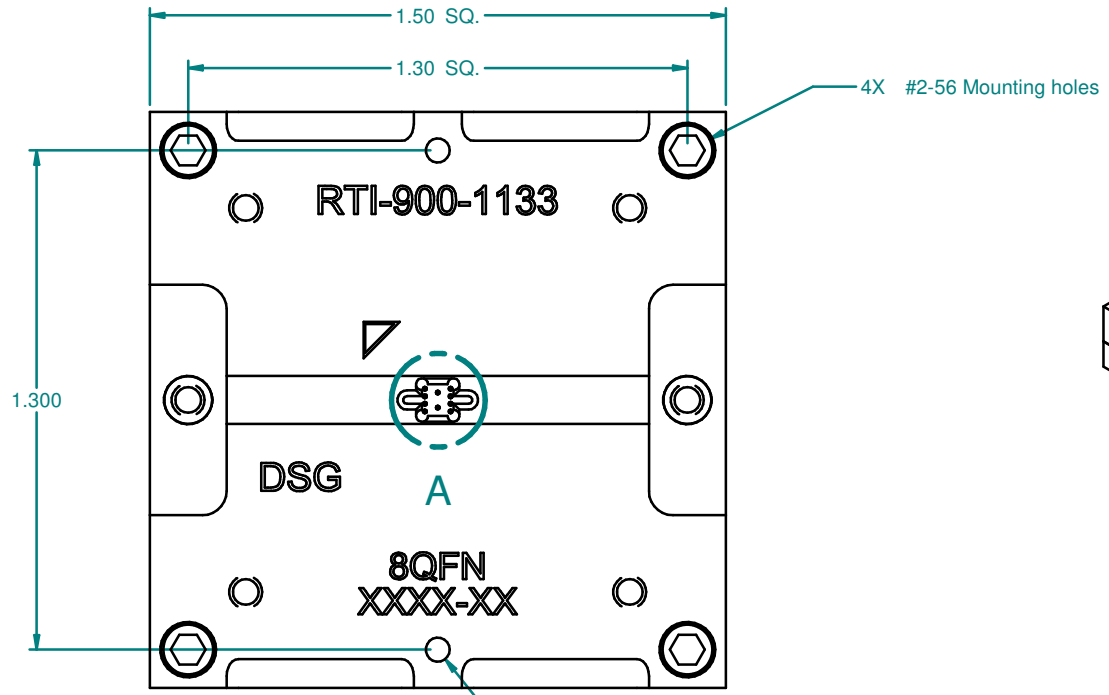

RTI CONFIDENTIAL		WWW.TESTFIXTURES.COM		
THESE DRAWINGS AND THE DATA CONTAINED THEREIN, ARE THE EXCLUSIVE PROPERTY OF RTI AND IS ISSUED IN STRICT CONFIDENCE AND SHALL NOT WITHOUT THE WRITTEN PERMISSION OF RTI, BE USED FOR ANY PURPOSE WHATSOEVER, EXCEPT THE MANUFACTURE OF ARTICLES FOR RTI.	THIRD ANGLE PROJECTION	MATERIAL:	ENG BY: MD	
		FINISH:	DWN BY: MD	
	UNLESS OTHERWISE SPECIFIED, DIMENSIONS ARE IN INCHES: .XX = ± .01 .XXX = +.002 .XXXX = ±.0005		CHECK BY:	DRAWING NUMBER: 1007120-C
	DATE: 09/26/17	REV: B	PAGE: 5 of 8	TITLE: Customer Specification



ROBSON TECHNOLOGIES, INC.
135 E. MAIN AVE., STE. 130, MORGAN HILL, CA 95037
PH: 408-779-8008 FAX: 408-782-7132

REV	DESCRIPTION	DATE	BY
A	PRELIMINARY DESIGN	09/26/17	MD
B	Adjust to Match PCB	10/3/17	MD

Socket Assembly

Sales Part# 900-1133-01-8+2QFN-2x2-0.5-00-L4056C

Material Specification:

Socket Top/Base - High Performance Plastic

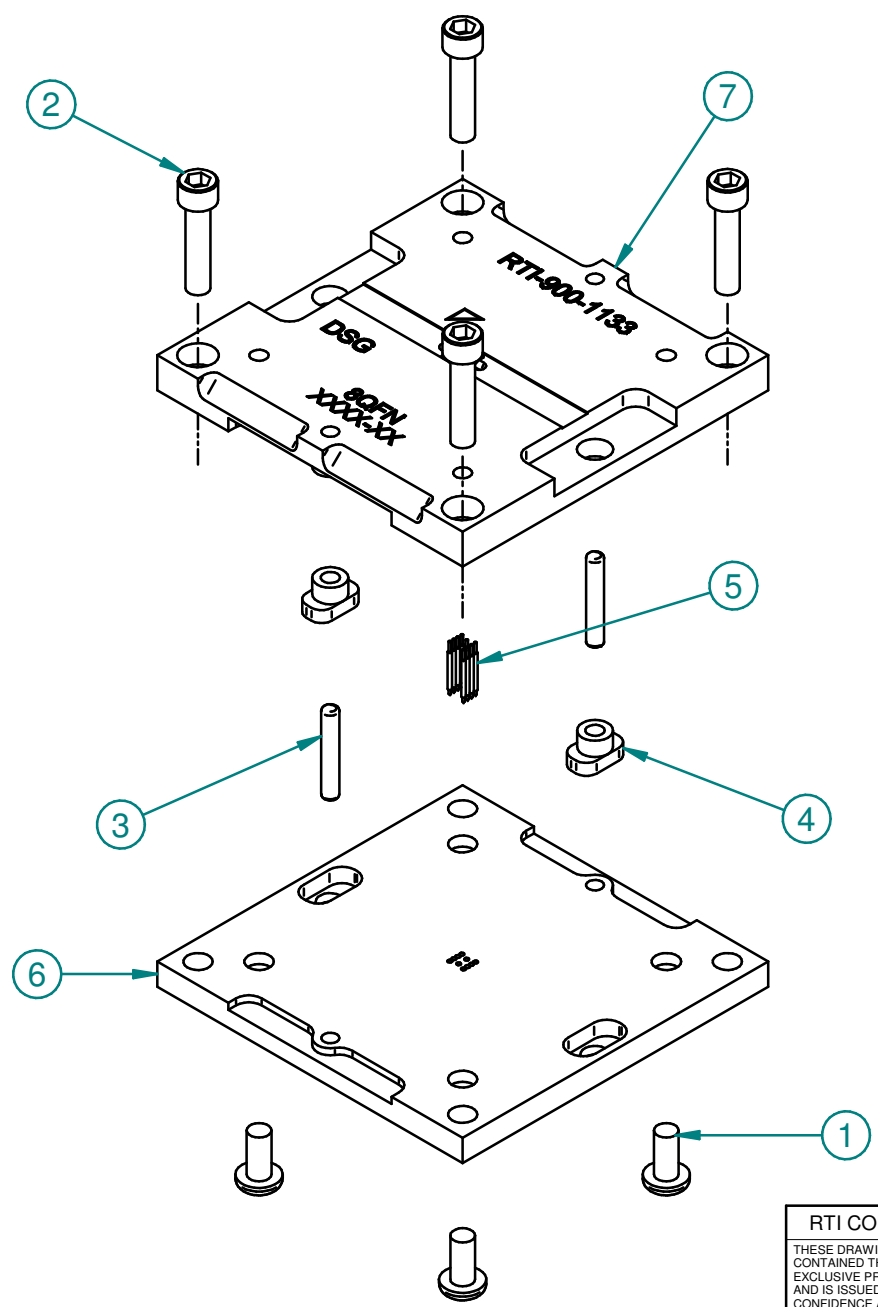

Item	Part Number	Rev	Title	Qty.
1	01-2-56x.187-MA-BNA-SS		Button Head Screw	4
2	01-2-56x.375-MA-SCA-SS		Socket Head Screw	4
3	02-.0625x.375-S-S		Dowel Pin	2
4	04-2-56x.125-Custom	1	Custom Insert	
5	L4056C		Test Probe	10
6	S-1133-SB-849	A	Socket Base	1
7	S-1133-ST-849	A	Socket Top	1

RTI CONFIDENTIAL WWW.TESTFIXTURES.COM

THESE DRAWINGS AND THE DATA CONTAINED THEREIN, ARE THE EXCLUSIVE PROPERTY OF RTI AND IS ISSUED IN STRICT CONFIDENCE AND SHALL NOT WITHOUT THE WRITTEN PERMISSION OF RTI, BE USED FOR ANY PURPOSE WHATSOEVER, EXCEPT THE MANUFACTURE OF ARTICLES FOR RTI.

THIRD ANGLE PROJECTION

MATERIAL: _____
FINISH: _____

ENG BY: MD
DWN BY: MD

CHECK BY: _____
DATE: 09/26/17

UNLESS OTHERWISE SPECIFIED, DIMENSIONS ARE IN INCHES:
.XX = ± .01
.XXX = ± .002
.XXXX = ± .0005

RTI **ROBSON TECHNOLOGIES, INC.**
135 E. MAIN AVE., STE. 130, MORGAN HILL, CA 95037
PH: 408-779-8008 FAX: 408-782-7132

DRAWING NUMBER: 1007120-C
REV. B
PAGE: 6 of 8

TITLE: Customer Specification

Socket Footprint

Sales Part# 900-1133-01-8+2QFN-2x2-0.5-00-L4056C

REV	DESCRIPTION	DATE	BY
A	PRELIMINARY DESIGN	09/26/17	MD
B	Adjust to Match PCB	10/3/17	MD

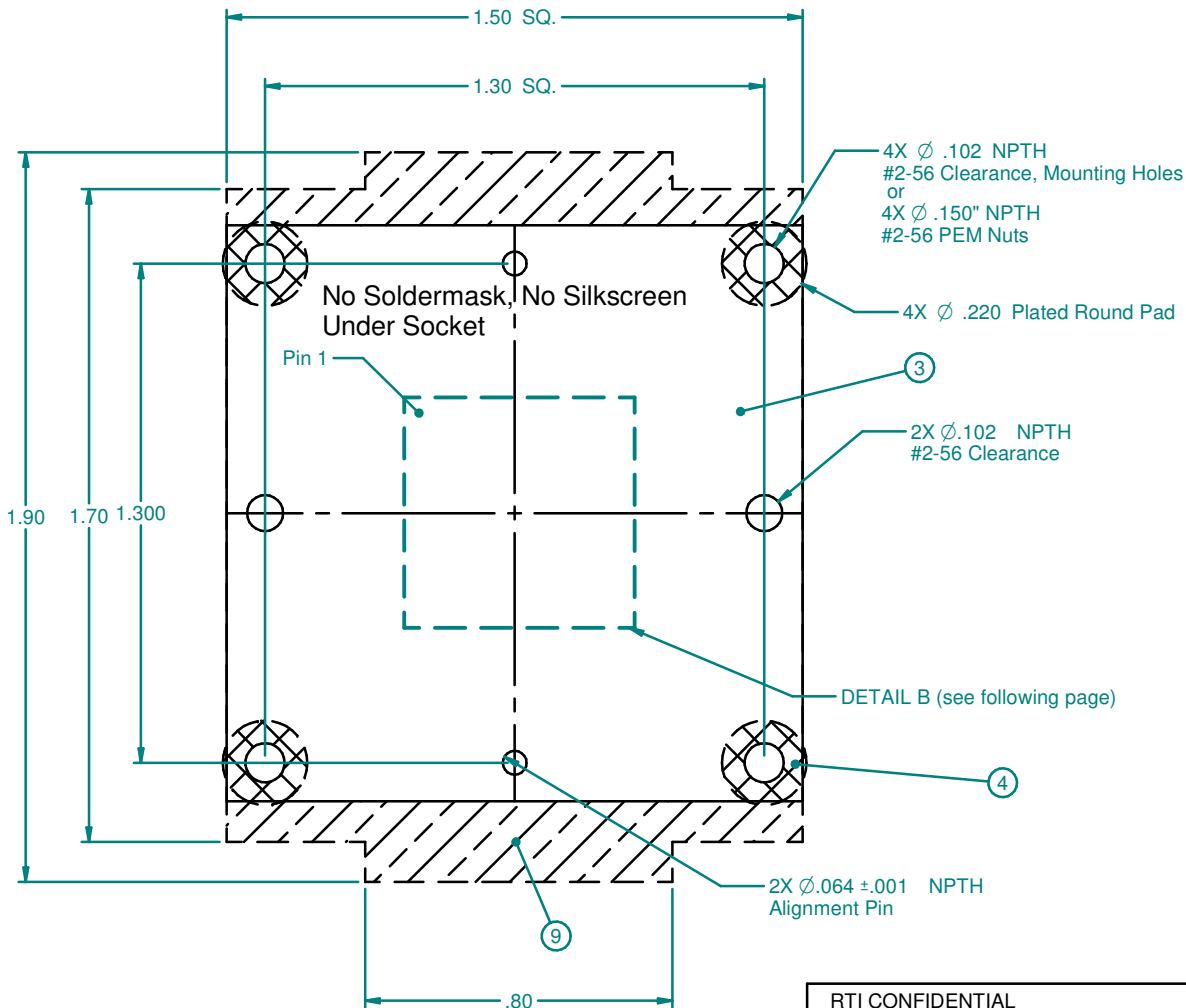

General Layout Specifications for PCBs using RTI Pogo-Pin Sockets:

1. Board must have a minimum of 30 micro-inches of hard gold over 200 micro-inches of Nickel.
2. RTI recommends the use of PEM nuts pressed into the DUT board for mounting the socket to the DUT board. PEM nuts require min. 0.062" thick PCB.
3. Area under socket must be free of all solder mask, hole burrs, etc.
4. There must be plated pads around the mounting holes. This is to keep the socket at the same height as the pogo-pin area of the socket.
5. If the DUT board is less than .095 inches thick, the use of a stiffener on the back side of the DUT board is recommended to prevent the DUT board from being warped.
6. There can be no vias in the pads. RTI recommends an off-set via pattern if required, or the use of plated-over vias.
7. Where stated, MM are controlling dimensions.
8. All hole sizes are finished size.
9. Shaded area must be clear of all devices on top side of PCB when using Dual Latch Lids.

RTI CONFIDENTIAL		MATERIAL:		ENG BY:	WWW.TESTFIXTURES.COM	
<small>THIRD ANGLE PROJECTION</small> 	FINISH:	ENG BY:	MD		ROBSON TECHNOLOGIES, INC. 135 E. MAIN AVE., STE. 130, MORGAN HILL, CA 95037 PH: 408-779-8008 FAX: 408-782-7132	
	<small>UNLESS OTHERWISE SPECIFIED, DIMENSIONS ARE IN INCHES:</small> .XX = ± .01 .XXX = ± .002 .XXXX = ± .0005	CHECK BY: DATE:	DWN BY: 09/26/17		MD	DRAWING NUMBER: 1007120-C
<small>THESE DRAWINGS AND THE DATA CONTAINED THEREIN, ARE THE EXCLUSIVE PROPERTY OF RTI AND IS ISSUED IN STRICT CONFIDENCE AND SHALL NOT WITHOUT THE WRITTEN PERMISSION OF RTI, BE USED FOR ANY PURPOSE WHATSOEVER, EXCEPT THE MANUFACTURE OF ARTICLES FOR RTI.</small>				TITLE: Customer Specification		

REV	DESCRIPTION	DATE	BY
A	PRELIMINARY DESIGN	09/26/17	MD
B	Adjust to Match PCB	10/3/17	MD

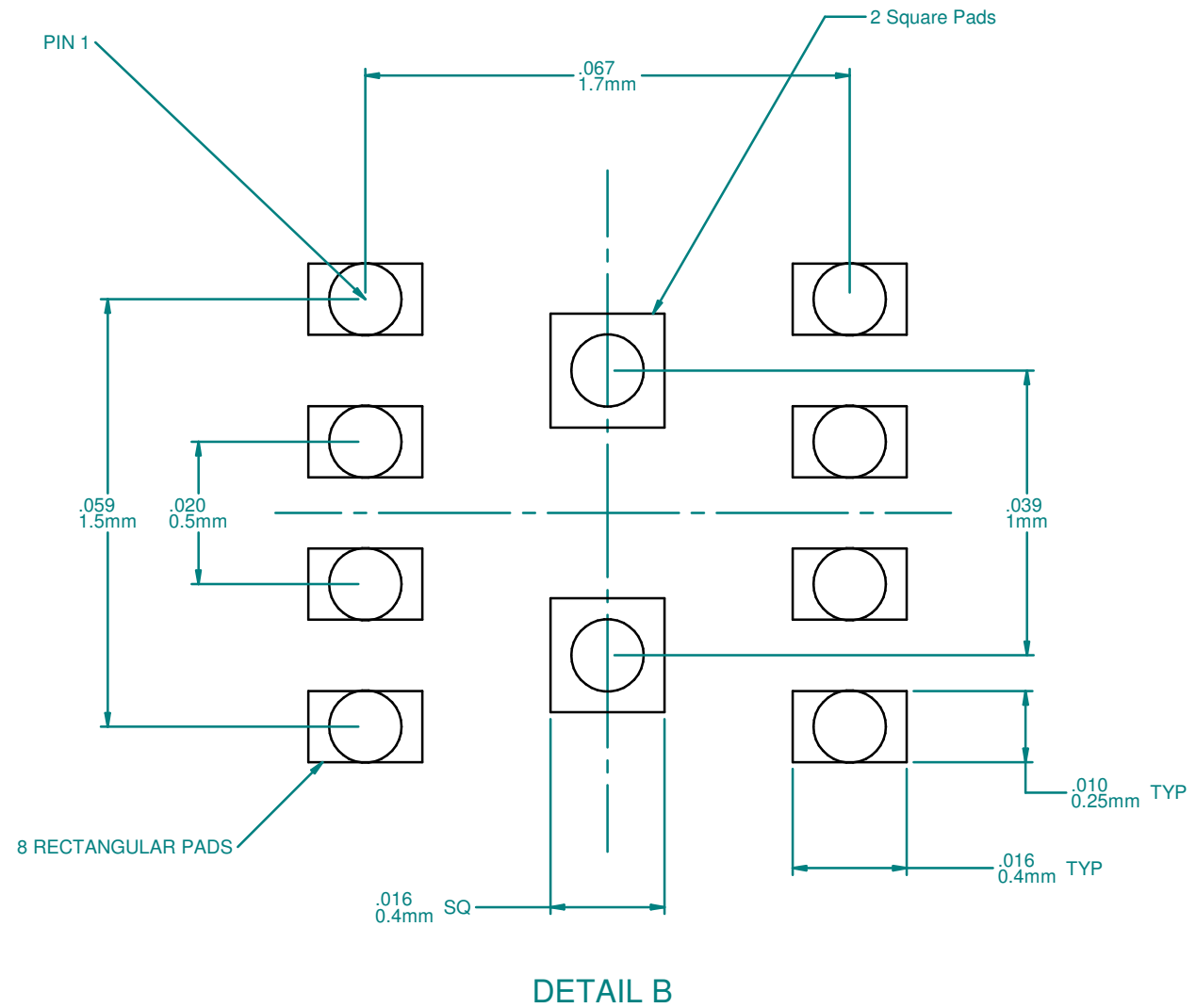

- Notes:
1. Controlling dimensions are mm
 2. Circle indicates pogo pin centers.
 3. Pad sizes are finished dimensions.
 4. Note Pin 1 location with respect to mounting holes.

RTI CONFIDENTIAL		WWW.TESTFIXTURES.COM	
THESE DRAWINGS AND THE DATA CONTAINED THEREIN ARE THE EXCLUSIVE PROPERTY OF RTI AND IS ISSUED IN STRICT CONFIDENCE AND SHALL NOT WITHOUT THE WRITTEN PERMISSION OF RTI, BE USED FOR ANY PURPOSE WHATSOEVER, EXCEPT THE MANUFACTURE OF ARTICLES FOR RTI.	THIRD ANGLE PROJECTION	MATERIAL:	ENG BY: MD
		FINISH:	DWN BY: MD
	UNLESS OTHERWISE SPECIFIED, DIMENSIONS ARE IN INCHES: .XX = ± .01 .XXX = ± .002 .XXXX = ± .0005		CHECK BY:
		DATE: 09/26/17	REV: B PAGE: 8 of 8 TITLE: Customer Specification



ROBSON TECHNOLOGIES, INC.
 135 E. MAIN AVE., STE. 130, MORGAN HILL, CA 95037
 PH: 408-779-8008 FAX: 408-782-7132